

planning drawing - site information

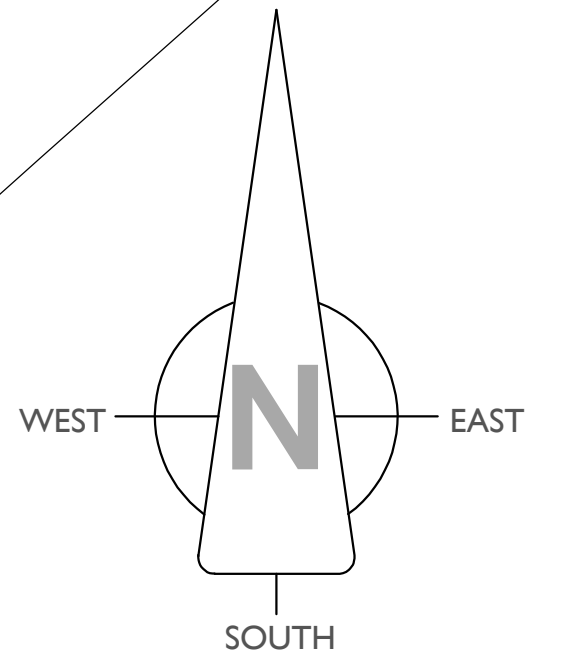

Pink hatched area denotes a Visibility splay which is to be set back 4.5m from the edge of the road and is to be set at 120.00m measured in south west direction and 81.00m measured in north east direction. There are to be no visual obstructions over the height of 1050mm (measured from the level of the carriageway) so as to ensure full view of visibility required. Vegetation will be cut back as necessary (ENTIRE AREA DENOTED IN PINK IS EITHER UNDER THE CONTROL OF STRATHDEE PROPERTIES LTD OR IS AN ADOPTED ROAD VERGE)



VISIBILITY SPLAY / LOCATION
PLAN (SCALE 1:2500)



Strathdee Properties Ltd.

VIEWFIELD FARM, CRAIGELLACHIE,
ABERLOUR, MORAY, AB38 9QT
- (01340) 881784 F - (01340) 881783



PROJECT
Proposed erection of dwellinghouse
with detached garage At Ben Aigen
Side, Craigellachie, Moray
For Mr Gavin Strathdee

DRAWING DESCRIPTION
PLANNING DRAWING - SITE INFORMATION

DRAWING no.
BEN-AIGEN-SIDE / PLANNING / 01

DRAWN BY
S.Reid MCIAT
Chartered Architectural Technologist

SCALE
500 & AS
TATED (A1)

ATE
April 2015



Craigellachie

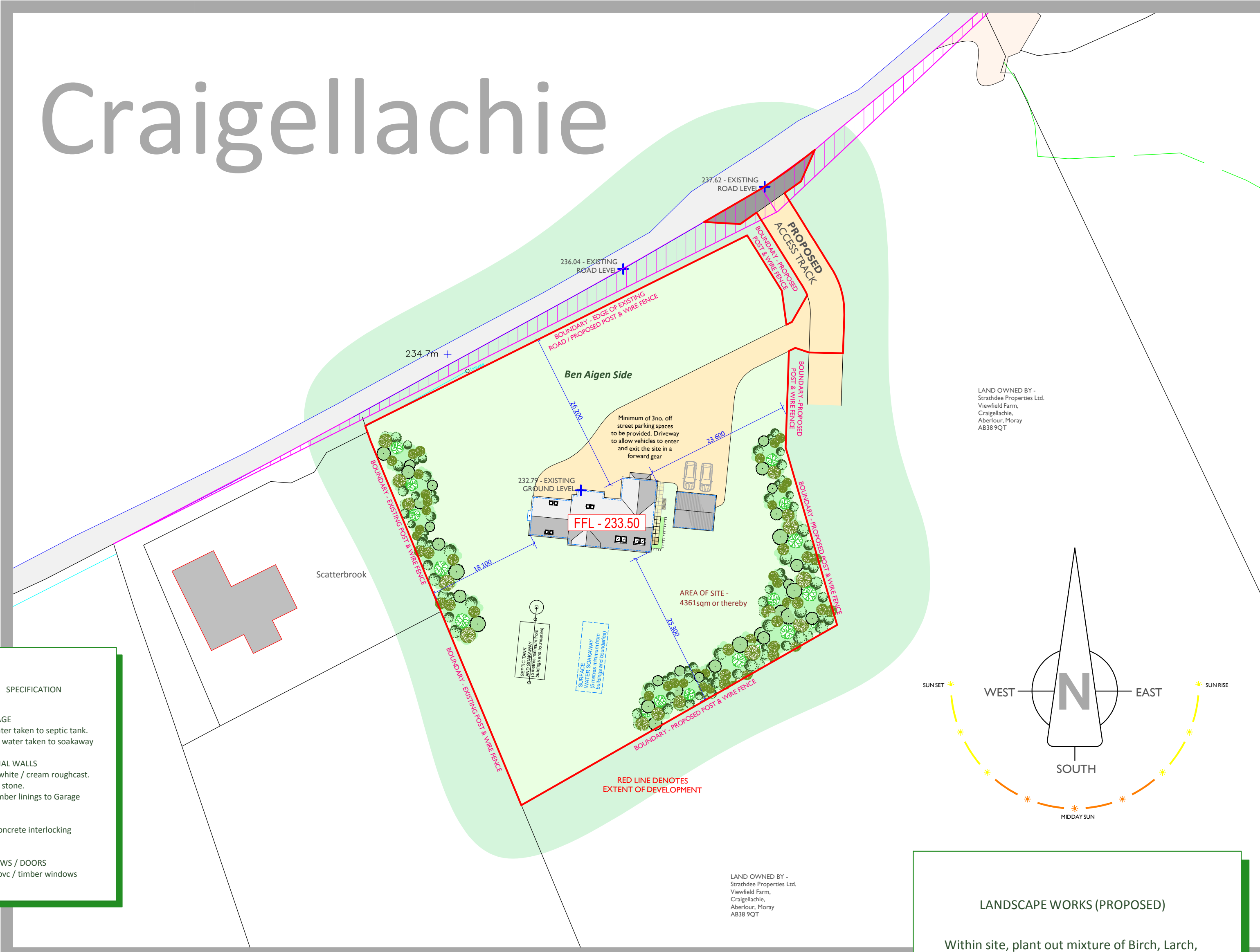

LAND OWNED BY -
Strathdee Properties Ltd
Viewfield Farm,
Craigellachie,
Aberlour, Moray
AB38 9QT

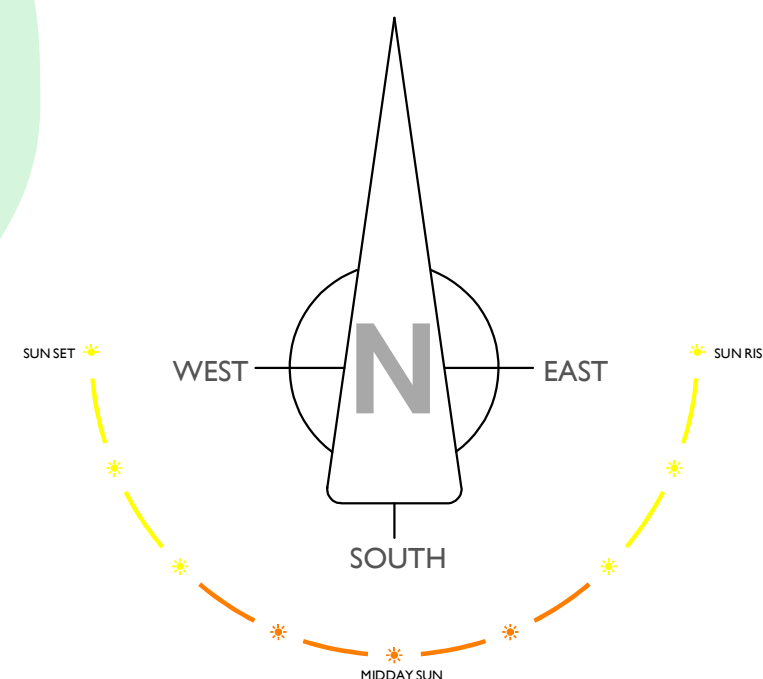

LANDSCAPE WORKS (PROPOSED)

Within site, plant out mixture of Birch, Larch, Rowan & Scot Pine trees and bushes at approx. 1.5m centres to give a 25% foliage cover. All trees to be at least 1.5m in height.

LAND OWNED BY -
Strathdee Properties Ltd.
Viewfield Farm,
Craigellachie,
Aberlour, Moray
AB38 9QT

SPECIFICATION

DRAINAGE
Foul water taken to septic tank.
Surface water taken to soakaway

EXTERNAL WALLS
20mm white / cream roughcast.
Natural stone.
Grey timber linings to Garage

ROOF
Grey, concrete interlocking
tiles

WINDOWS / DOORS
Grey Upvc / timber windows

SITE PLAN (SCALE 1:500)