

4864 5726 1000
 1133 1460 1204 740 327 590 2188 170 2188 590

Install stove (Termatech TT40R stove) in accordance with manufacturers recommendations and Building Standards. Metal flue as per spec. For section of single skin prior to joining to Selkirk flue there requires to be a non combustible material acting as a shield. This will be placed at min 12mm from wall to provide an air gap. The flue should be placed 1.5 x D (300mm) from the shield

Town & Country Planning (Scotland) Act, 1997 as amended
REFUSED
 22.06.2015
 Development Management Environmental Services, The Moray Council

drainage s/vp with access at base. 2 layers of pbd, fully insulated

walls adjacent to any sanitary facility that are of rebase construction that will permit secure fixing of grab rails with the use of 9mm ply behind plasterboard

Remove ex Building inc foundations. All existing services to be disconnected prior to commencement. Public to be protected from works with the use of heras panels. Make area good.

CHECK DOOR HEAD HEIGHT BENEATH STAIRS

project PROPOSED NEW HOUSE
 address 7 DUFF STREET, HOPEMAN IV30 5RZ
 client MRS J GOVIER
 date OCT 2014
 scale AS SHOWN

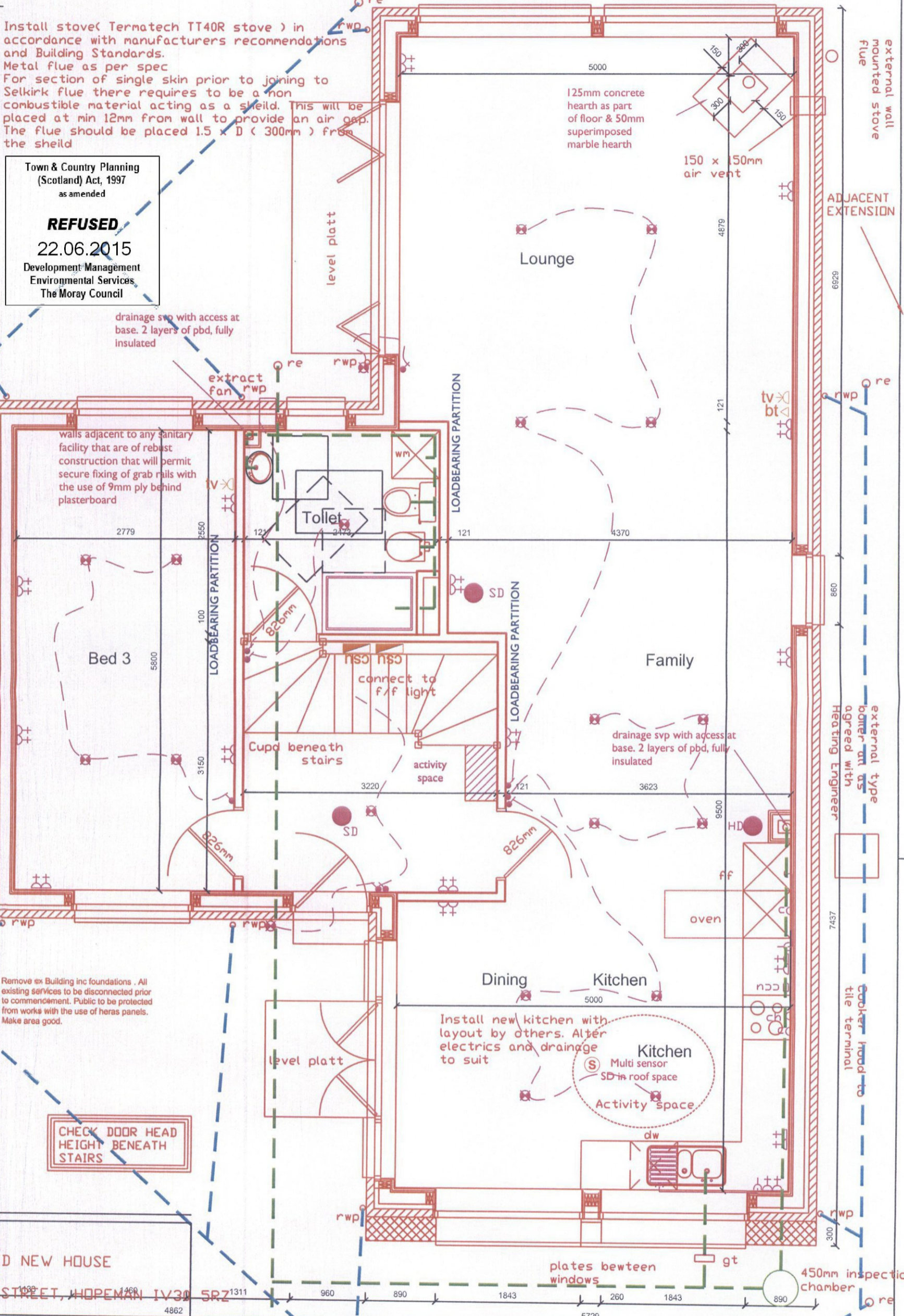

GROUND FLOOR PLAN
 scale 1:50

15/00648/APP
 06 APR 2015