

Bar Mark	Type & Size	Total No.	Length	Shape Code	A	B	C	D	E
21	T16	12	11300	51	4600	800	325	325	
22	T16	12	8225	41	1425	800	4600	800	725
23	T16	12	8875	41	1425	770	4600	770	1425
24	T16	12	2950	20	2950				
25	T16	12	4025	11	325	3725			
26	T16	12	11150	51	4600	770	325	325	
27	T16	3	6700	51	2400	770	325	325	

Town & Country Planning
(Statutory) Act, 1987
as amended

REFUSED

28.6.11
Development Management
Environmental Services
The Mayor Council

27 (INNER)

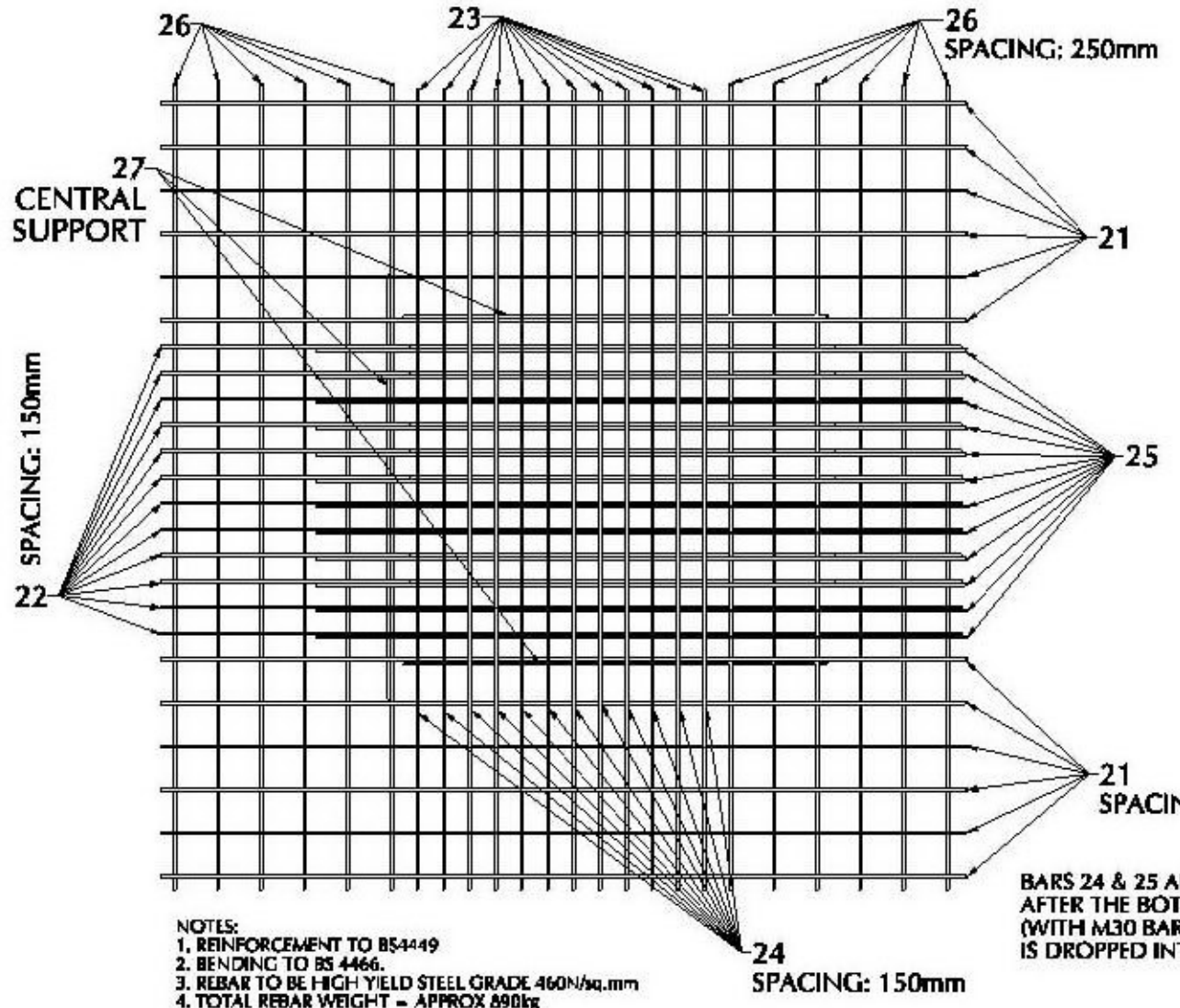

21 (OUTER)

22 (OUTER)

23 (INNER)

24 (OUTER)

25 (OUTER)

26 (INNER)

- NOTES:
1. REINFORCEMENT TO BS4449
2. BENDING TO BS 4466.
3. REBAR TO BE HIGH YIELD STEEL GRADE 460N/sq.mm
4. TOTAL REBAR WEIGHT = APPROX 890kg

BARS 24 & 25 ARE SPLICED IN AFTER THE BOTTOM TEMPLATE (WITH M30 BARS) IS DROPPED INTO THE CAGE

C&F Green-Energy		PART NUMBER A-0920	
DESCRIPTION: 5.0m REBAR SCHEDULE		QTY PER UNIT:	1
MATERIAL: -		SCALE:	-
DRAWN: C. O'Neill	PAINT: -		DWG SIZE: A4
CHECKED: -	FINISH: -		DATE: 03-Aug-10
DATE: 03-Aug-10		SHEET: 1 OF 1	