

Proposed erection of dwellinghouse with detached garage At South Oldtown, Oldtown, Mulben, by Craigellachie, Moray For Mr Gavin Strathdee

PLANNING DRAWING - SITE INFORMATION

Pink hatched area denotes a Visibility splay which is to be set back 4.5m from the edge of the road and is to be set at 120.00m measured in both directions. There are to be no visual obstructions over the height of 1000mm (measured from carriageway) so as to ensure full view of visibility required. Existing post and wire fence to be repositioned behind splay to ensure full visibility is achieved. (ENTIRE AREA DENOTED IN PINK IS UNDER THE CONTROL OF STRATHDEE PROPERTIES LTD OR IS A MORAY COUNCIL ROAD VERGE)

Typical 3d image of house design
Produced using TurboCAD V.18 professional, 3DS max, design 2011 and Photoshop

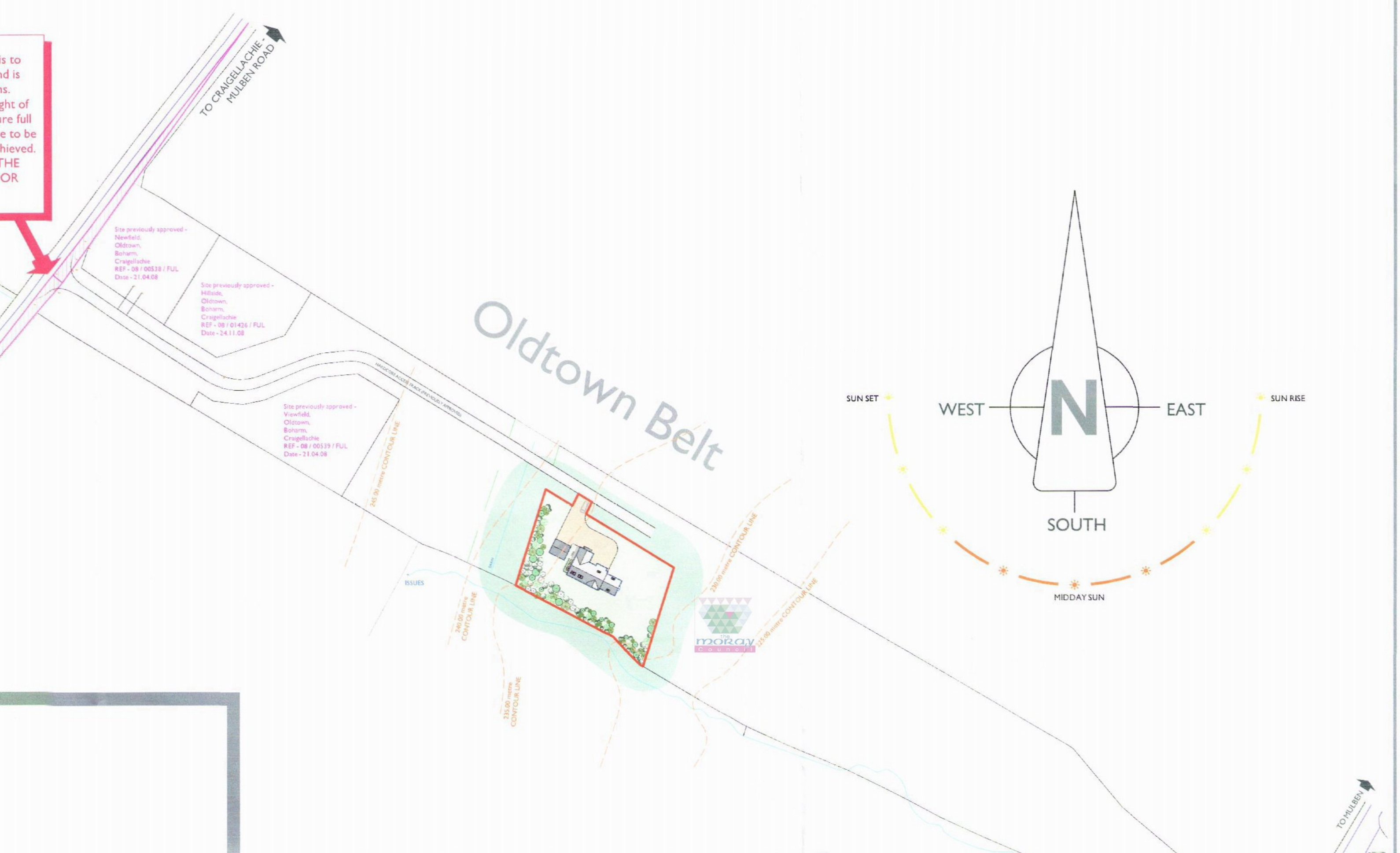

location plan (scale - 1:1250)

Town and Country Planning (Scotland) Act, 1997
as amended
REFUSED
08.08.2013
Development Management
Environmental Services
Moray Council

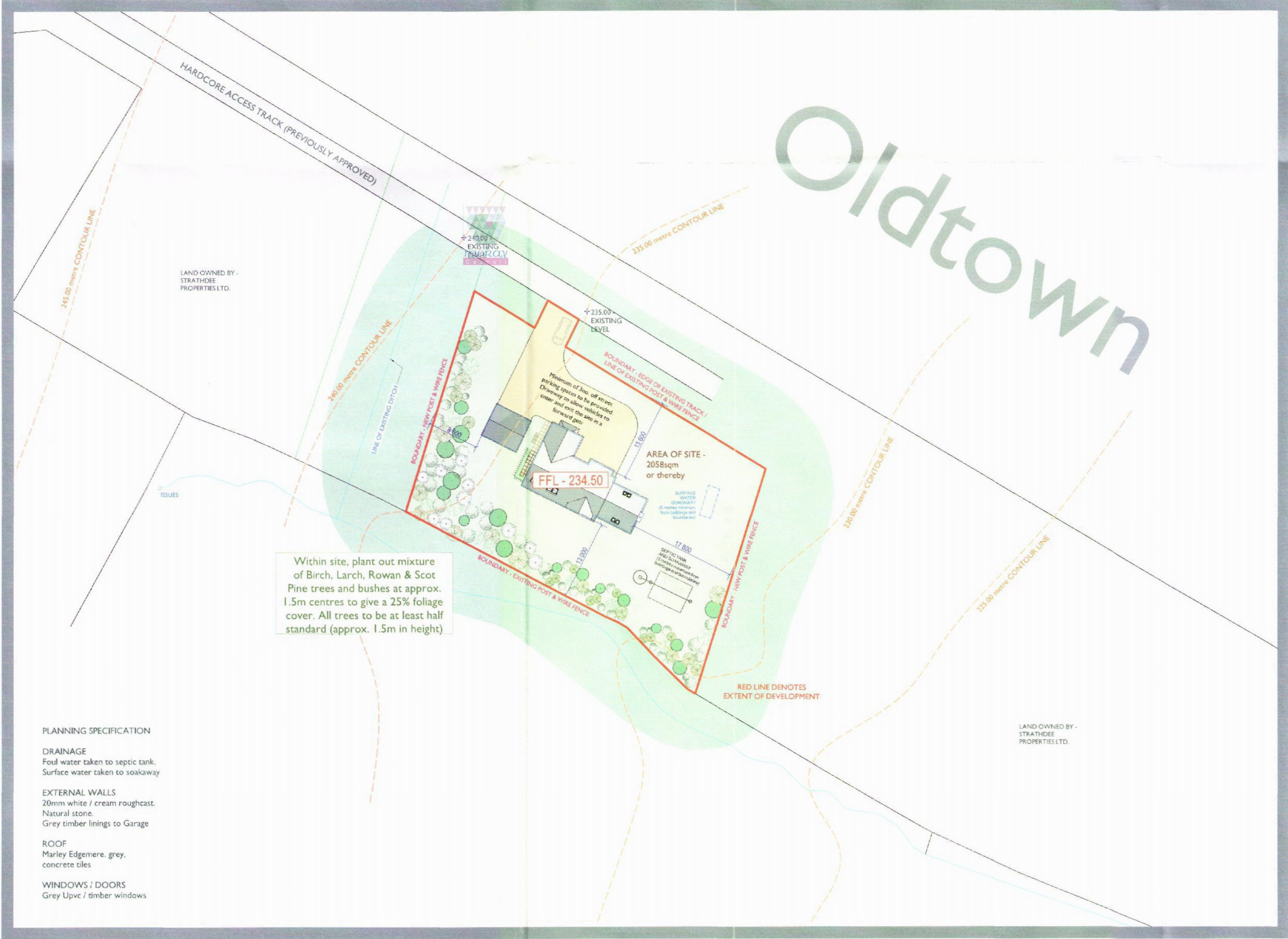

Within site, plant out mixture of Birch, Larch, Rowan & Scot Pine trees and bushes at approx. 1.5m centres to give a 25% foliage cover. All trees to be at least half standard (approx. 1.5m in height)

- PLANNING SPECIFICATION
- DRAINAGE**
Foul water taken to septic tank.
Surface water taken to soakaway
 - EXTERNAL WALLS**
20mm white / cream roughcast.
Natural stone.
Grey timber linings to Garage
 - ROOF**
Marley Edgemoor, grey, concrete tiles
 - WINDOWS / DOORS**
Grey Upvc / timber windows

site plan (scale - 1:500)

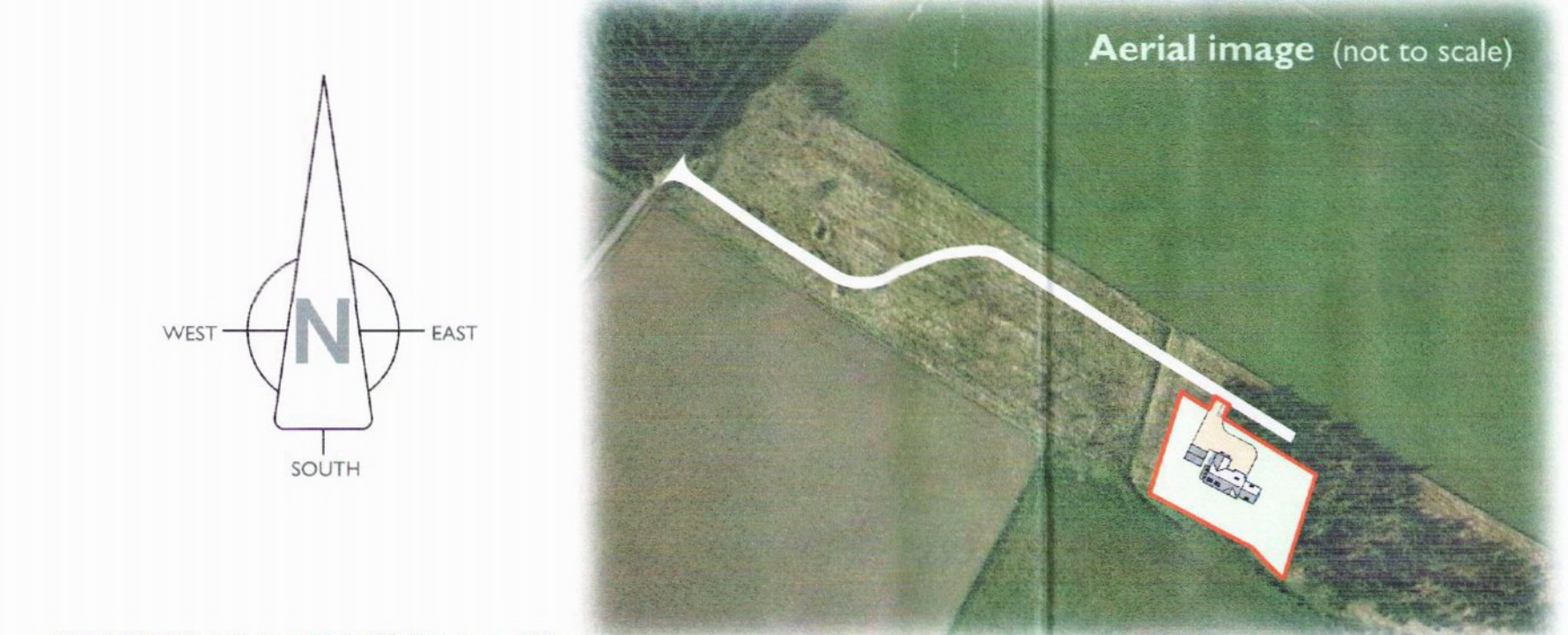

Aerial image (not to scale)

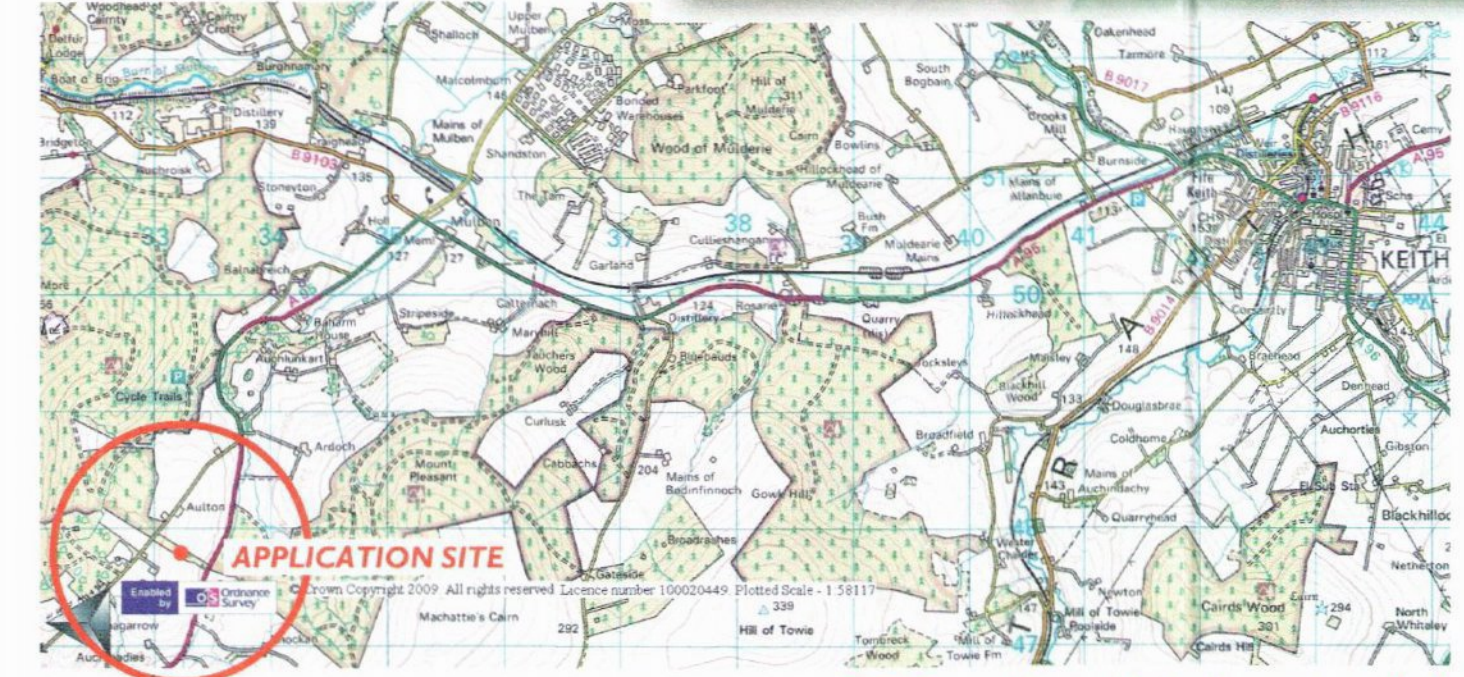

OS location plan (not to scale)



Strathdee Properties Ltd.

VIEWFIELD FARM, CRAIGELLACHIE,
ABERLOUR, MORAY, AB38 9QT
T - (01340) 881784 F - (01340) 881783

PROJECT
Proposed erection of dwellinghouse with detached garage At South Oldtown, Oldtown, Mulben, by Craigellachie, Moray For Mr Gavin Strathdee

DRAWING DESCRIPTION
PLANNING DRAWING - SITE INFORMATION

DRAWING no.
SOUTHOLDTOWN / PLANNING / 01

SCALE
1:500 & AS STATED (A1)

DRAWN BY

DATE