

## Appendix 13 – Proposed visibility splay as submitted

The drawing contained in this appendix shows a visibility splay that complies with current Council standards. The strip marked green on the splay to the east indicates an area where our client has the agreement of the proprietor of Arradoul House to enter his grounds, if necessary, in order to cut back any vegetation that is growing into the splay. Bearing in mind the line and width of the splay at that point, this is seen very much as a belt and braces precaution as our client could probably deal with such an occurrence from the public footpath and most likely with no need to enter the grounds of Arradoul House.

n.b. The green mark on the drawing only indicates the length of the splay affected . The width of splay potentially affected by the agreement is very narrow and can be seen by following the lines of the splay below the green marking.

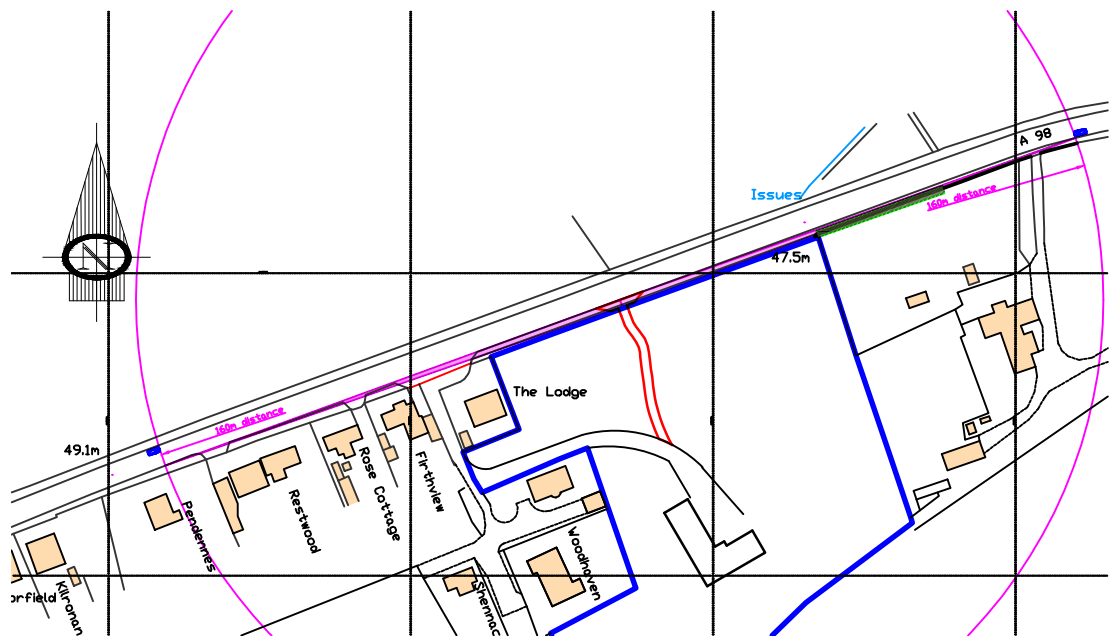

location plan  
1:2500

Crown copyright and database right.  
All rights reserved. Ordnance Survey  
Licence N° AR 00032309.

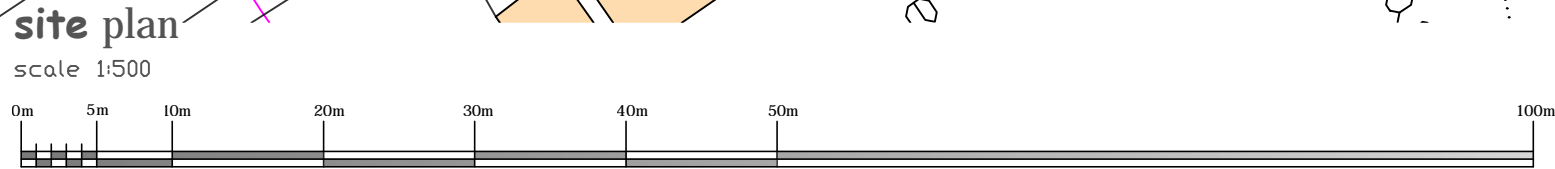
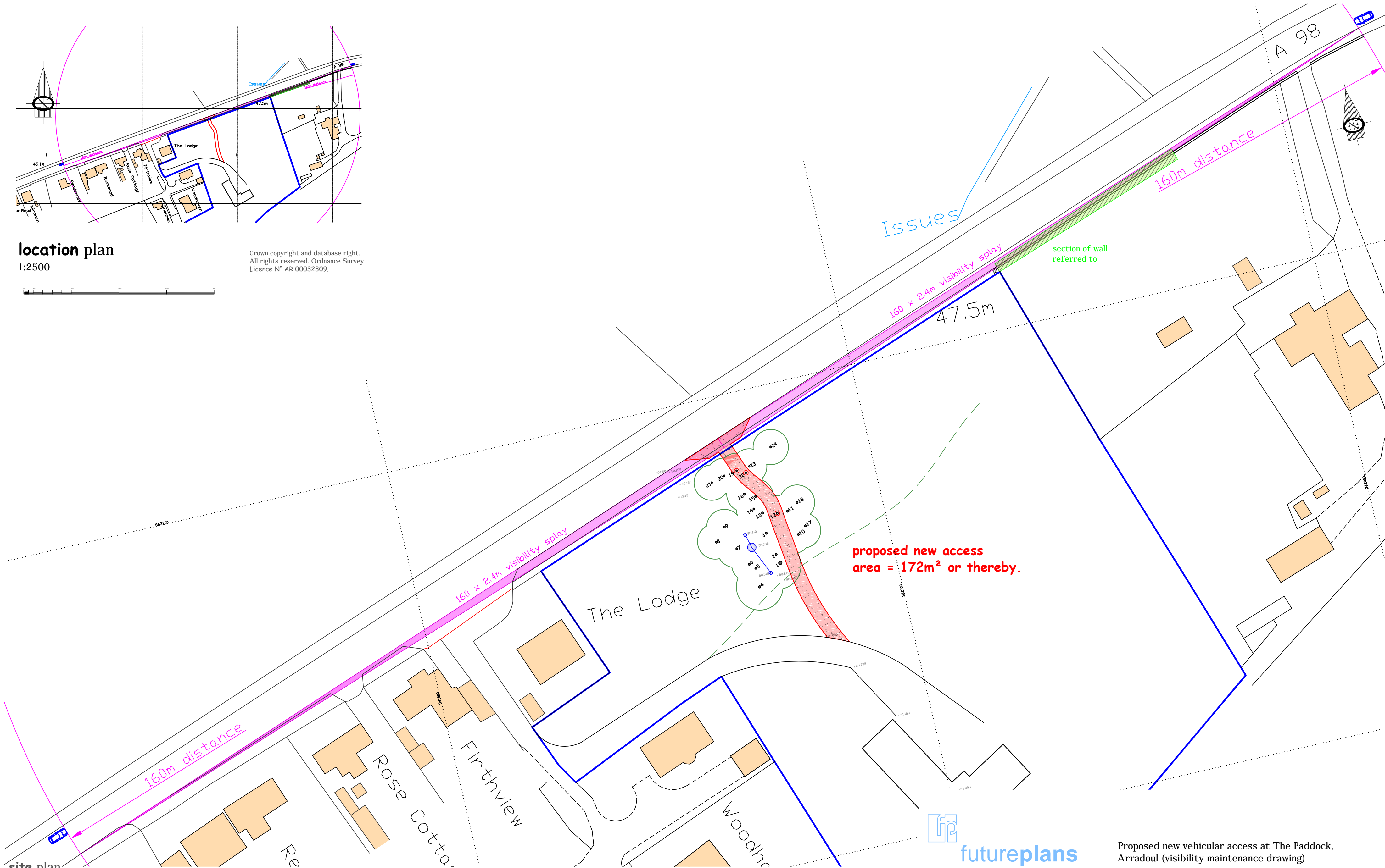

**futureplans**  
architects & planners

The Barnyard Studios, Upper Garmouth, Moray 01343 870007

Dimensions not to be scaled. ©Future Plans reserve all copyrights in respect of the contents of this drawing.

Proposed new vehicular access at The Paddock,  
Arradoul (visibility maintenance drawing)

Scale: as shown (A2)

Date: 26th September 2013

Job N°: 706/1012/T

Rev:

Drg No: 2.